

# Quick Start

## Leica DISTO™ X310

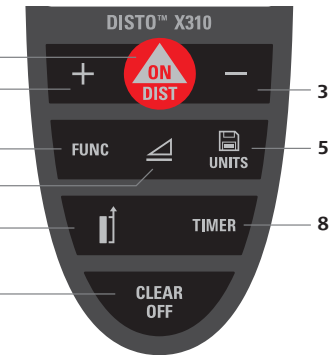

- 1 ON/DIST (on/measure)
- 2 Add
- 3 Subtract
- 4 Functions
- 5 Memory/Unit
- 6 Smart Horizontal Mode™
- 7 Measuring reference
- 8 Timer
- 9 Clear/Off

- when it has to be **right**

**Leica**  
Geosystems

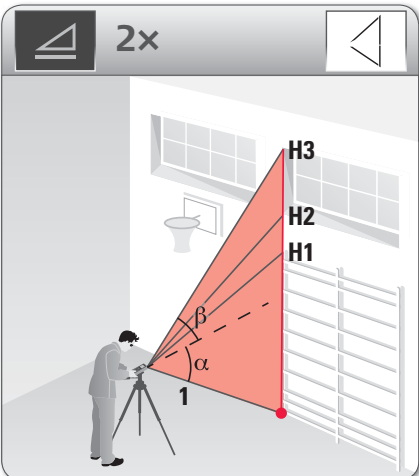
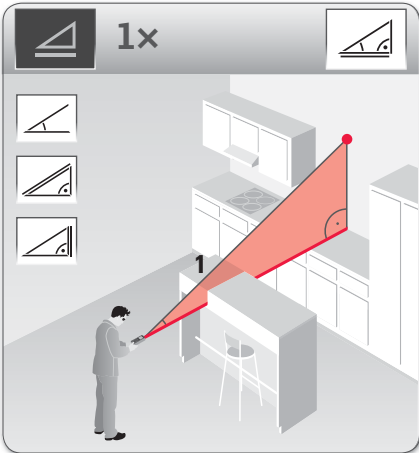

**Reference**

↑ 1x      ↓

↑ 2 sec.      ↓

→ permanent

**Tripod**

↑ 2x      ↓

↑ 3x (default)      ↓

**UNITS** 1x      [UNITS]

→ history (1-20)

+ 1 ... 20

- 20 ... 1

[UNITS] 2 sec.

→ use for calculations

[CLEAR OFF] + [UNITS] 2 sec.

→ delete history

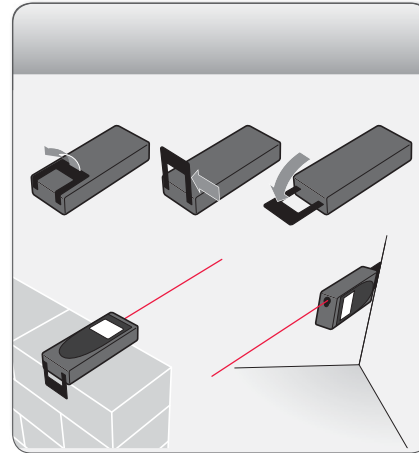

**Key Combinations**

↑ + - 2 sec.      [Mute]

↑ + + 2 sec.      [Light]

[UNITS] + [ANGLE] 2 sec.

→ change tilt units

[UNITS] 2 sec.

→ change units

**Keylock ON** [Lock]

[CLEAR OFF] - 2 sec.

→ [Lock]

KEY LOCK

On

**Keylock OFF** [Unlock]

[ON/DIST]

→

PRESS MINUS

<2 sec. - → [Unlock]

**ON DIST** 1x → ON  
**CLEAR OFF** 2 sec. → OFF

**ON DIST** 1x

**ON DIST** 2 sec.

**FUNC** 1x → **FUNC** 2 sec.

**FUNC** 3x → **FUNC** 2 sec.

**FUNC** 5x

**FUNC** 2x → **FUNC** 2 sec.

**FUNC** 4x

**FUNC** 6x



Laser class 2 in acc. to IEC 60825-1

[www.disto.com](http://www.disto.com)



SAP. No. 788 481

