



Laser class 2 in acc. to IEC 60825-1

[www.disto.com](http://www.disto.com)



SAP.No. 788 219

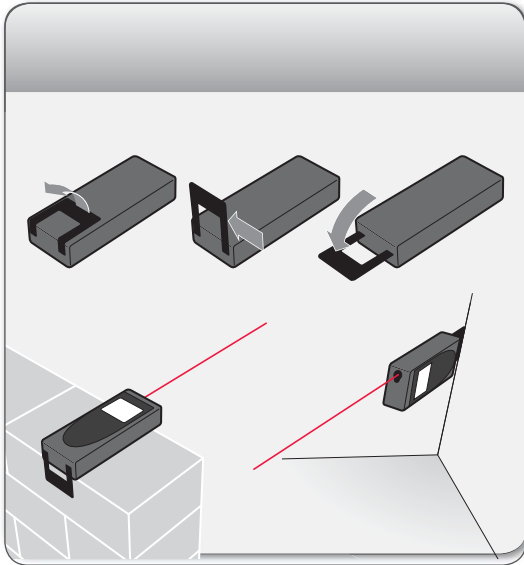

**Keylock ON**

**CLEAR OFF** + **-** 2 sec.  
→

1x

2 sec.

→ permanent

**Key Combinations**

+ **-** 2 sec.  
→ /

+ **+** 2 sec.  
→ /

**+** + **-** 2 sec.  
→ change units

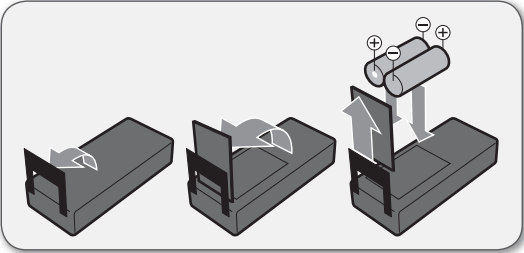

**Keylock OFF**

→

< 2 sec. **-** →

# Quick Start

## Leica DISTO™ D210

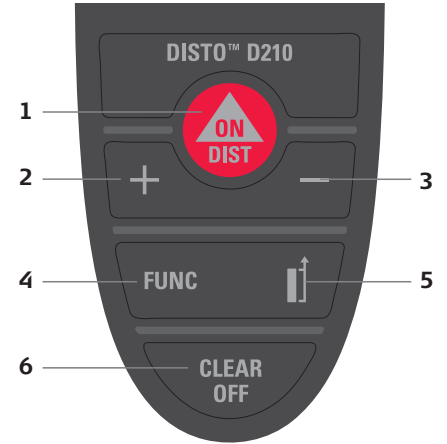

- 1 ON/DIST (on/measure)
- 2 Add
- 3 Subtract
- 4 Functions
- 5 Measuring reference
- 6 Clear/Off

- when it has to be **right**





1x → ON



2 sec. → OFF



1x



2 sec.

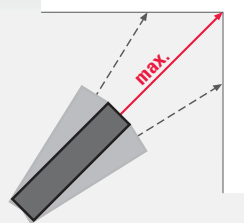
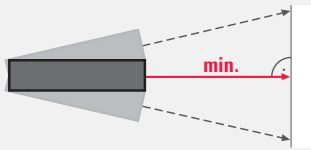

**FUNC** 1x

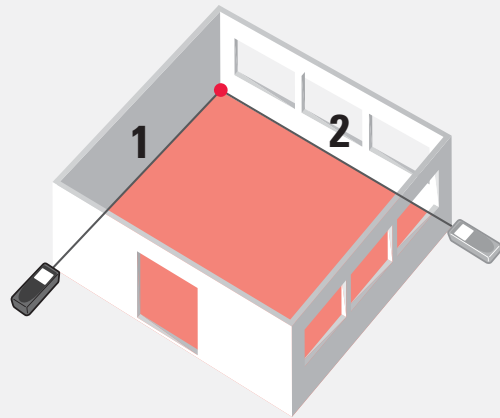

**FUNC** 3x



→ History (1-10)

+ 1 ... 10

- 10 ... 1

**CLEAR OFF** + **FUNC** 2 sec.

→ delete history

**FUNC** 5x

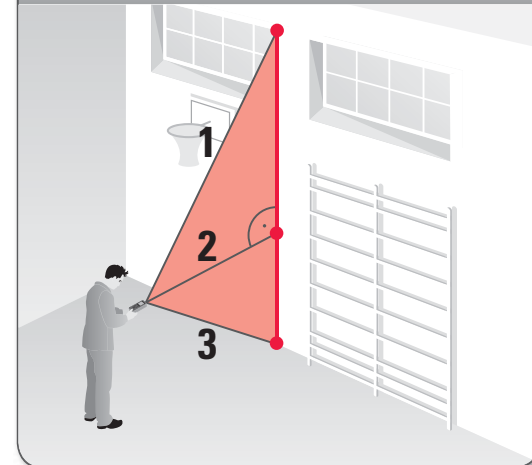

**FUNC** 2x

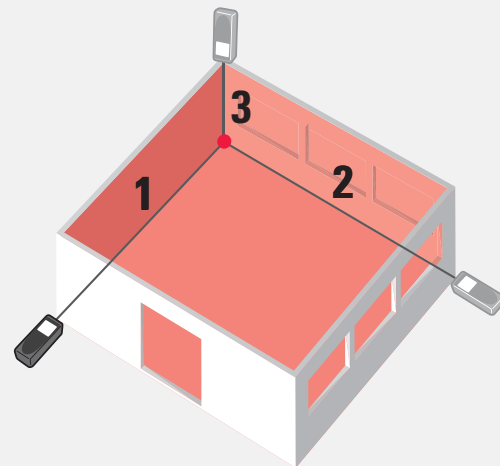

**FUNC** 4x

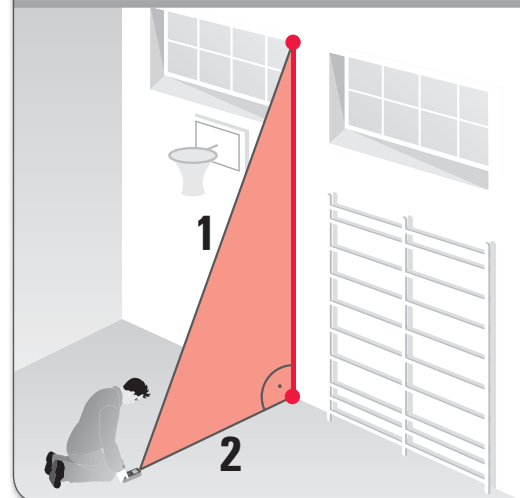

**FUNC** 6x

