



Quick Start

Leica DISTO™ D110

Laser class 2 in acc. with IEC 60825-1

www.disto.com



SAP. No. 812 796

Change Units

Switch between the following units:

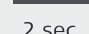
	0.000 m	0.00 ft
	0.0000 m	0'00" 1/32
2 sec		0 in 1/32

Bluetooth®

-  1x send
- 2 sec deactivate/activate

Insert Batteries

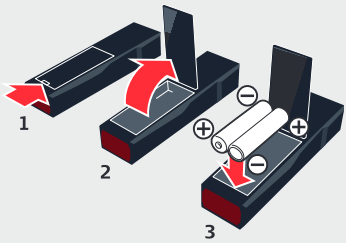

Operation



1x → ON



2 sec → OFF



1x 

- 1 ON/DIST
- 2 Area
- 3 Bluetooth®
- 4 Clear/Off

- when it has to be **right**



Attach/Remove Clip

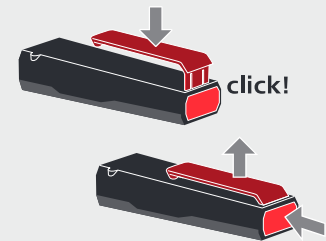

Area

